

OWNER'S MANUAL

MODEL NO.
HHU-2045

⚠ CAUTION

For Safe Operation
Read Rules And
Instructions Carefully

STATEMENT OF POLICY

It is the policy of **Worksaver, Inc.** to improve its products where it is possible and practical to do so. **Worksaver, Inc.** reserves the right to make changes or improvements in design and construction at any time, without incurring the obligation to make these changes on previously manufactured units.

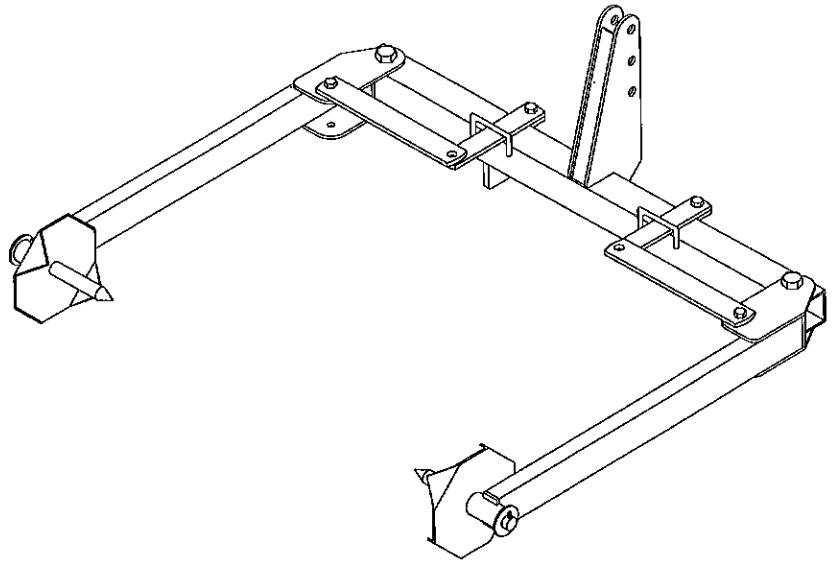

HAY HANDLER / UNROLLER

Packing
Assembly & Mounting
Operating Instructions

Maintenance
Repair Parts

⚠ CAUTION

THE FOLLOWING SAFETY PRECAUTIONS SHOULD BE THOROUGHLY UNDERSTOOD
BEFORE ATTEMPTING TO BEGIN ASSEMBLING THIS MACHINE.

1. Select an area for assembly that is clean and free of any debris which might cause persons working on the assembly to trip.
2. Do not lift heavy parts or assemblies. Use crane, jack, tackle, fork trucks or other mechanical devices.
3. Preview the assembly instructions in your operator's manual before proceeding further.
4. If the assembly instructions call for parts or assemblies to be blocked up, use only blocking material that is in good condition and is capable of handling the weight of the assembly to be blocked. Also insure that the blocking material is on a clean, dry surface.
5. Never put hands, or any other part of body, under blocked up assemblies if at all possible.
6. After completing assembly, thoroughly inspect the machine to be sure that all nuts, bolts, hydraulic fittings or any other fastened assemblies have been thoroughly tightened.
7. Before operating the machine, thoroughly read the operation section of your operator's manual.
8. Before operating, read the maintenance section of your operator's manual to be sure that any parts requiring lubrication, such as gearboxes, are full, to avoid any possible damage.
9. **Before operating equipment - If you have any questions regarding the proper assembly or operation, contact your Worksaver dealer or representative.**

WORKSAVER, INC.

P.O. Box 100, Litchfield, Illinois 62056-0100

(217) 324-5973



HHU-2045 HAY HANDLER / UNROLLER REPAIR PARTS LIST

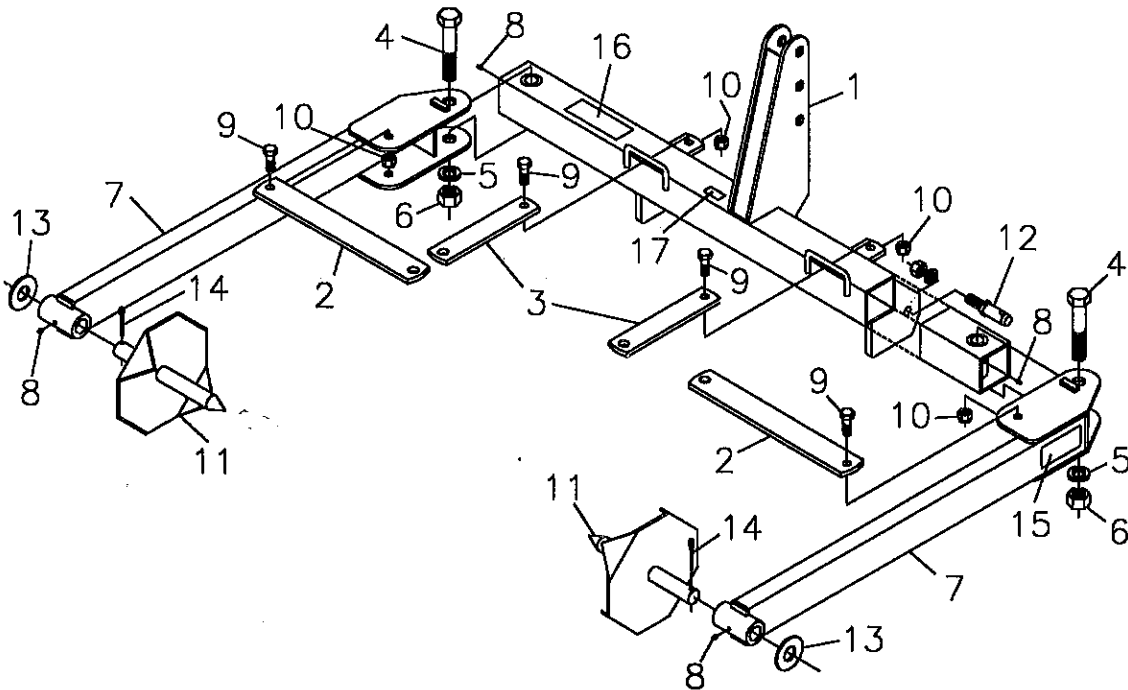

NOTE: The bolts (Ref. #4) should be inserted with the head of the bolt against the welded tab on the clamp arm. This welded tab ensures that the bolt moves with the arm, which distributes the load over the entire bushing and bolt surface. This installation will result in one bolt head up and the other down.

REF. NO.	PART NO.	DESCRIPTION	NO. REQ'D.
1	831349	Main Frame Weldment	1
2	831341	Push Arm	2
3	831342	Cylinder Pivot Arm	2
4	2503177	Bolt, 1 1/4" - 7 NC x 6 1/2" Hex Head	2
5	2502012	Washer, 1 1/4" Spring Lock	2
6	2500066	Nut, 1 1/4" - 7 NC Full Hex	2
7	831350	Clamp Arm Weldment	2
8	2504049	Drive Zerk, 5/16"	4
9	2503002	Bolt, 3/4" - 10 NC x 2" Hex Head	4
10	2500037	Nut, 3/4" - 10 NC Hex Nylock	4
11	831324	Spike Weldment	2
12	590078	Draw Pin (AK-2118)	2
13	2501016	Washer, 1 1/2" Flat	2
14	2504003	Cotter Pin, 1/4" x 2 1/2"	2
15	101027	Decal - Warning (Stand Clear)	2
16	101034	Decal - Caution (Hay Equipment)	1
17	101041	Decal - Notice (2000 Lb. Capacity)	1

BELOW.

the tractor.
ow down on
r may need
alance the

there is no

ditches or

ublic roads
cle emblem
g lights at
lity.

, use extra
and when

proper posi-

as the rear

care and
nily and

LER

m defects
purchase.
e any part
lose to be

rts broken
cidentally
rough use

rein are in

